

# VTEC

## Rocker Arms — Inspection Using Special Tools (D16Y2 engine)

### CAUTION

- Before using the Valve Inspection Tool, make sure that the air pressure gauge on the air compressor indicates over 250 kPa (2.5 kgf/cm<sup>2</sup>, 36 psi).
- Inspection the valve clearance before rocker arm inspection.
- Cover the timing belt with a shop towel to protect the belt.
- Check the intake mid rocker arm of each cylinder at TDC.

1. Remove the cylinder head cover.

NOTE: Refer to page 6-55 when installing cylinder head cover.

2. Plug the relief hole with the special tool (Air Stopper).

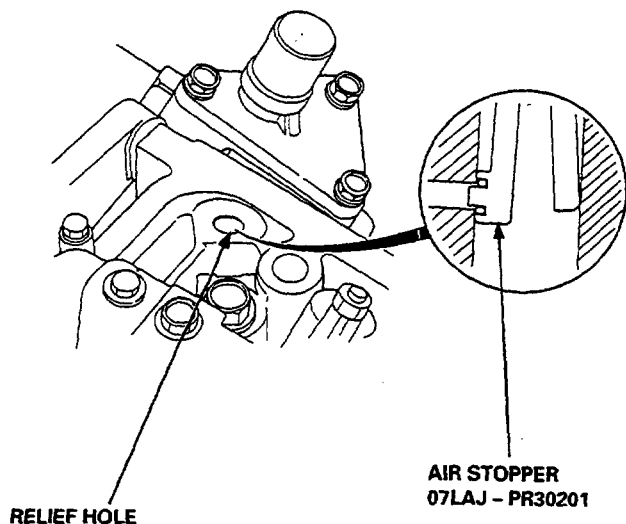

3. Remove the sealing bolt from the inspection hole and connect the Valve Inspection Tool.

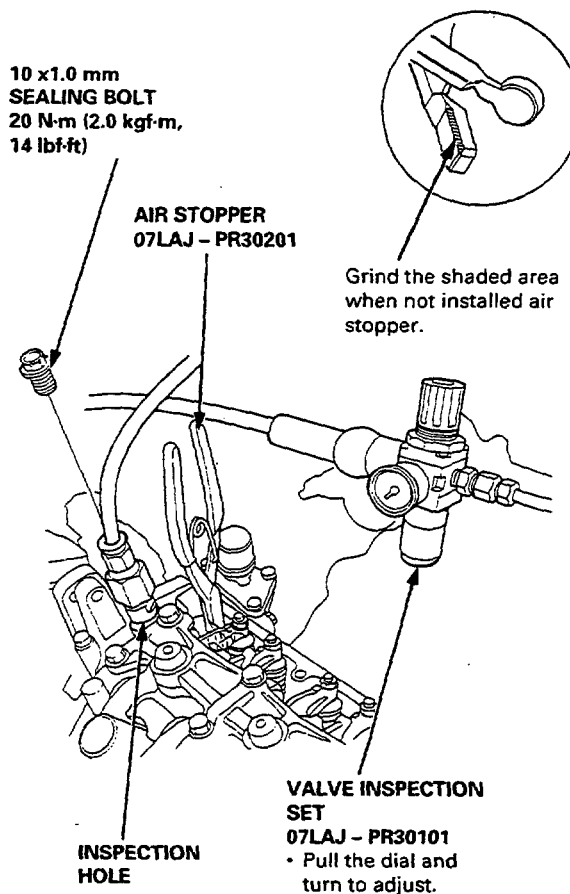



4. Apply specified air pressure to the rocker arm synchronizing piston A/B, after loosening the regulator valve on the valve inspection set.

**Specified Air Pressure:**  
250 kPa (2.5 kgf/cm<sup>2</sup>, 36 psi)

5. Make sure that the intake primary and secondary rocker arms are mechanically connected by piston and that the mid rocker arm does not move when pushed manually.

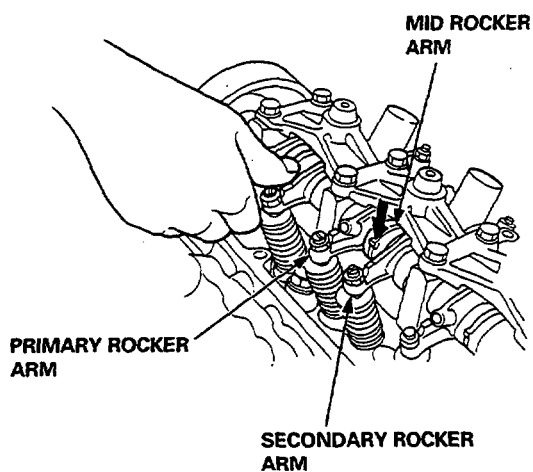

- If the intake mid rocker arms move independently of the primary and secondary rocker arms, replace the rocker arms as a set.

6. Remove the special tools.

7. Check for smooth operation of the lost motion assembly. It is compressed slightly when the intake mid rocker arm is lightly pushed and compressed deeply when the mid rocker arm is strongly pushed.
  - Replace the lost motion assembly if it does not move smoothly.

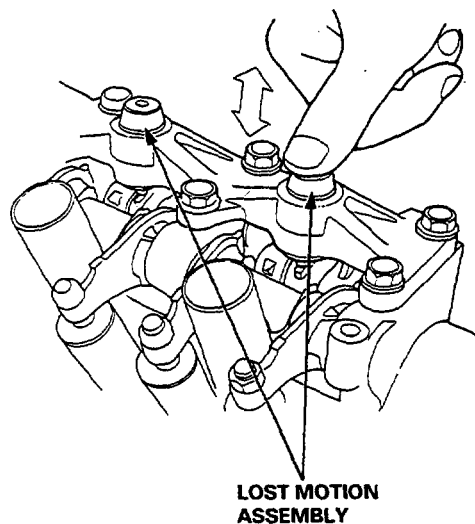

8. After inspection, check that the MIL does not come on.